



60 Croydon Road, Caterham,
Surrey, CR3 6QB

SUBSTANTIAL CLASS 'E'
/ RETAIL PREMISES

TO LET

PROPERTY SUMMARY

- Large Class 'E' / retail premises to let
- Excellent town centre location, close to all amenities
- Close to M25 Junction 6 and Caterham Railway Station
- Total net internal area 3,862 sq.ft (358.79 sq.m)
- Rent £45,000 per annum exclusive
- Parking potentially available

LOCATION

The premises occupies an excellent location within the centre of Caterham Valley close to a wide variety of shops, restaurants and other local amenities and opposite the new supermarket / residential development.

Caterham benefits from good road and rail connections with Junction 6 of the M25 close-by at Godstone. There is also a Mainline Railway Station within easy walking distance providing regular services to Croydon and London.

DESCRIPTION & ACCOMMODATION

The property comprises a substantial Class 'E' / retail unit which was until recently used as a children's soft play centre and cafe. The premises are well configured with a large rectangular retail area with storage space to the rear. There is some parking potentially available with the unit. The accommodation and net internal floor areas are as follows:-

Retail area	3,261 sq.ft	(302.96 sq.m)
Rear storage areas	601 sq.ft	(55.83 sq.m)
Total	3,862 sq.ft	(358.79 sq.m)

TERMS

The premises are available to let on a new effective full repairing and insuring lease for a term to be agreed at an initial rent of £45,000 per annum exclusive.

The existing fixtures and fittings are available by way of separate negotiation.

Subject to contract

VAT

We understand that VAT is **not** applicable to the rent.

RATES

The Valuation Office Agency Website describes the property as "Shop & Premises" and advises that the 2023 Rateable Value is £29,500. The current UBR is 49.9 pence in the £.

EPC – Awaiting EPC.

LEGAL COSTS - Each party to bear their own costs.

For further information or to view please contact

Jamie Christian MRICS Tel: 01737 222835

Email: jamie@raynerscommercial.com

Chris Richards MRICS Tel: 01737 222835

Email: chris@raynerscommercial.com

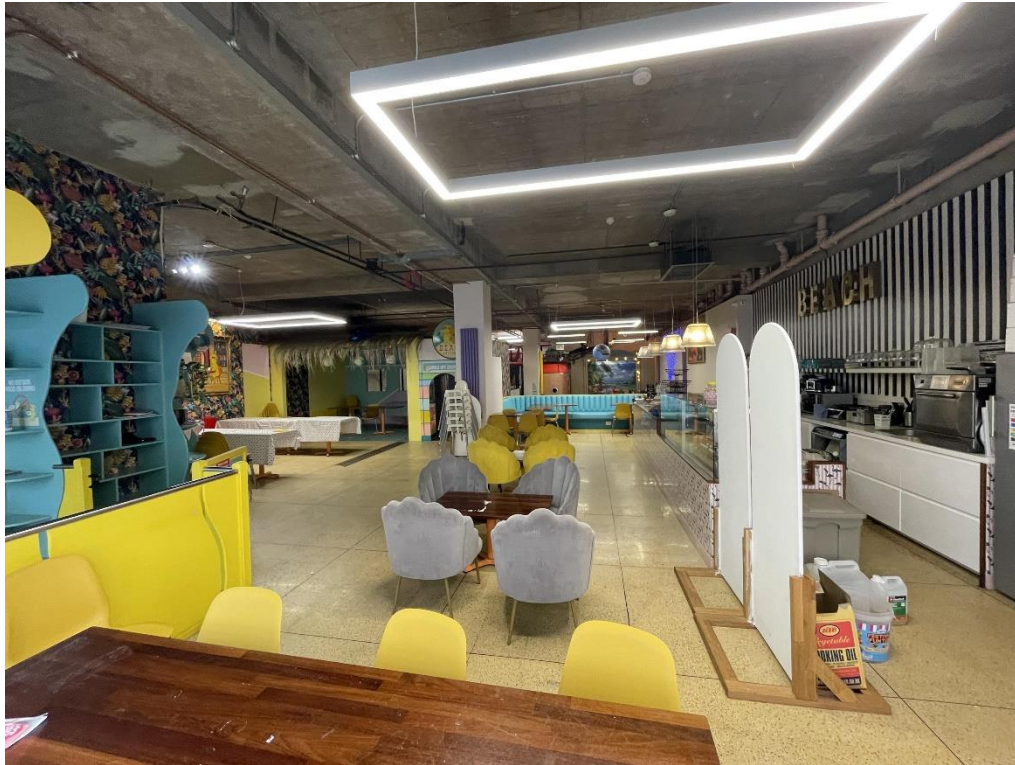

DISCLAIMER

Richards & Co (UK) Ltd trading as Rayners Commercial, for themselves and for the sellers or owners of this property, whose agents they are, give notice that (i) the particulars and any further information communicated to potential purchasers of the property, or their advisers are provided solely for the purpose of assisting potential purchasers or tenants in deciding whether they wish to proceed with further investigation of the property and do not constitute either the whole or any part of an invitation, offer or contract for sale of the property; (ii) all descriptions, dimensions, photographs, references to condition and necessary permissions or licences for use and occupation and other details are given in good faith and are believed to be correct as at the date of the particulars. However, potential purchasers are not entitled to rely on them as statements or representations of fact but should satisfy themselves by searches, enquiries, surveys and inspections or otherwise with regard to the accuracy of such details.

No responsibility or liability is or will be accepted by Richards & Co (UK) Ltd, the seller(s) or owners of the property or any of their respective, affiliates, directors, officers, representatives, employees, advisers, or agents for any loss or damage suffered by any party, resulting from reliance on the particulars or any other information communicated by any means to that party, or its advisers, in connection with the possible sale or letting of the property.

No person in the employment of Richards & Co (UK) Ltd or the vendor(s) or owners has authority to make or give any representation or warranty, express or implied, in relation to the property. Richards & Co (UK) Ltd include any joint agents acting with Richards & Co (UK) Ltd.

The price or rent may be subject to VAT and any prospective buyer or tenant must satisfy themselves concerning the correct VAT position.